



**METASEC - ASSEMBLY POINT**  
**TERMINAL FOR THE**  
**EVACUATION**



META  SEC

made  
in  
Germany

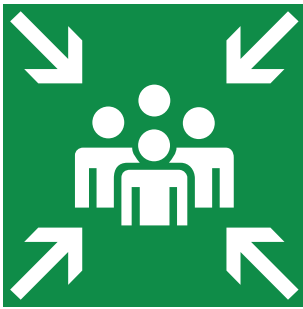

## EVACUATE SAFELY WITH THE METASEC ASSEMBLY POINT

Evacuation in case of an alarm is an individual and complex process. In this case, particularly people such as suppliers and visitors always represent the weakest links in the process chain. They usually do not know the terrain and don't know where the assembly points are, nor are they familiar with the correct behavior. Therefore, it is particularly important to take these peoples by their hands or to include them in an evacuation plan.

With our evacuation terminal and in connection with JAMES (our visitor management - shown here yellow), ROGER (our alarm server in red) and Midas (green) cover all variants of these complex processes.

A seamlessly integrated workflow with access control, location determination of individual persons, building guidance systems and the possibilities of a broadband alarming up to check-in at the collecting point, guarantee a fast and secure evacuation.

In addition to emergency conferences, which can be convened directly between the individual pillars, the assembly points also have a direct connection to the respective control room. Here, for example, recordings and protocols can be viewed and evaluated directly.

Comprehensive reporting on evacuation is also taking place. This helps to evaluate the measures and can help to improve the next evacuations.

For further options and functions, we have compiled the following pages. Please do not hesitate to contact us for further information or individual advice. We would be pleased to show you the possibilities of our software and hardware based on your specific situation.



## THE MOST IMPORTANT FUNCTIONS FOR THE EVACUATION:



Dynamic escape route marking



Digital Signage



QR Code Reader



Terrain maps



Self Check-In terminal support



Control of visitors flows



Connection to access control systems



Reporting



Emergency conferences



Recordings and logging



Consolidated reports on tactical dashboards



Connection to the control room



## ASSEMBLY POINT - SAFE EVACUATION AND LOCATION DETERMINATION

In the case of an evacuation, the reliable determination of regular staff and visitors at the designated collecting points, especially on large terrains, is often difficult to handle.

With the idea of the active collecting point, this demand can be solved quite simply and with the user. Regular employees register with their access control cards or time recordings at the assembly point. Visitors, on the other hand, scan a QR code or use the manual key input on the terminal.

The visualization of the acquired data can be transferred to third party systems in real time.

**The individual functions of the terminal in the overview:**

- Especially easy to use QR code based tickets
- Intercom for emergency conferences
- Multilingualism
- Instruction in local safety guidelines
- Connection to the access control

\* The terminal can optionally be equipped with a QR code scanner, a speech station as well as a touch panel. In the standard condition, the delivery only includes the regular reader for access control.





## THE MOST IMPORTANT FUNCTIONS OF THE ASSEMBLY POINT TERMINAL:



QR-Code-Reader



Access control-reader  
(Connection to access control systems)



Touch panel



Intercom



Multilingual translation with JAMESlingo



Welcome screens in national language

## ASSEMBLY POINT PILLAR

The pillar is configured and populated according to customer requirements and can be produced in different dimensions and colors.

The selection of the individual modules (QR Code Scanner, Intercom, etc.) is tailored directly to your needs.

\* The pillar can optionally be equipped with a QR code scanner, a speech station as well as a touchpanel. In the standard, delivery includes only the regular reader for access control.



## PRODUCT DATA

|                                 |                          |   |
|---------------------------------|--------------------------|---|
| <b>Pillar</b>                   | <b>Material</b>          | stainless steel                                     |
|                                 | <b>Dimension (BxTxH)</b> | 490 x 350 x 2000 mm (bottom plate ca. 800 x 800 mm) |
|                                 | <b>Weight</b>            | ca. 80-100 kg                                       |
|                                 | <b>Colour</b>            | stainless steel / white powder-coated (RAL)         |
| <b>Display</b>                  | <b>Size</b>              | 32" Full Touch Display 16:9 / 820 mm screen size    |
|                                 | <b>Resolution</b>        | Full HD Display (1920 x 1080)                       |
| <b>Environmental conditions</b> | <b>Temperature</b>       | -20 / +70°C   |
|                                 | <b>Humidity</b>          | 10-80%  |
|                                 | <b>Protection class</b>  | IP 20   |
| <b>Interfaces</b>               | <b>Connections</b>       | Power supply, network, USB                          |

## ASSEMBLY POINT TERMINAL



\* The terminal can optionally be equipped with a QR code scanner, a speech station as well as a touchpanel. In the standard, delivery includes only the regular reader for access control.

## PRODUCT DATA

|                                 |                   |   |
|---------------------------------|-------------------|---|
| <b>Terminal</b>                 | Material          | sheet steel                               |
|                                 | Dimension (BxTxH) | 380 x 180 x 304 mm                        |
|                                 | Weight            | ca. 10 kg                                 |
|                                 | Colour            | powder-coated (RAL)                       |
| <b>Display</b>                  | Size              | 15" Full Touch Display / screen ratio 4:3 |
|                                 | Resolution        | Full HD Display (1920 x 1080)             |
| <b>Environmental conditions</b> | Temperature       | -20 /+70°C                                |
|                                 | Humidity          | 10-80%                                    |
|                                 | Protection class  | IP 54                                     |
| <b>Interfaces</b>               | Connections       | Power supply, network, USB                |

## ASSEMBLY POINT STEELE

The interactive steele (stand pillar) is configured and populated according to customer requirements and can be produced in different dimensions and colors.

The selection of the individual modules (QR Code Scanner, Intercom, etc.) is tailored directly to your needs.

\* The steele can optionally be equipped with a QR code scanner, a speech station as well as a touchpanel. In the standard, delivery includes only the regular reader for access control.



## PRODUCT DATA

|                                 |                   |   |
|---------------------------------|-------------------|---|
| <b>Steele</b>                   | Material          | stainless steel                             |
|                                 | Dimension (BxTxH) | 300 x 65 x 1700 mm                          |
|                                 | Weight            | ca. 00-00 kg                                |
|                                 | Colour            | stainless steel / white powder-coated (RAL) |
| <b>Display</b>                  | Size              | 15" oder 21.5" Full Touch Display           |
|                                 | Resolution        | Full HD Display (1920 x 1080)               |
| <b>Environmental conditions</b> | Temperature       | -20 /+70°C                                  |
|                                 | Humidity          | 10-80%                                      |
|                                 | Protection class  | IP 20                                       |
| <b>Interfaces</b>               | Connections       | Power supply, network, USB                  |



## SELF CHECK-IN PILLAR

The models shown here can also be used as self check-in terminals for attendance management at receptions or at the goods entrance.

You can find more information on our website or ask for our self check-in brochure.



More information about the self check-in pillar you can get here:

[learn more](#)

The self check-in pillar brochure you can download here.

[learn more](#)



## ROGER – SILENT ALARM OR FACTORY/ PLANT ALARM

Automated notification, silent alarming, or access to persons or groups is a current topic.

Our alarm server covers efficiently and flexible various features, among others fast reaction after accidents on factory area or a subtle rescue alarm during escalation scenarios.

The server can be used in different modi:

- silent alarming
- Plant alarming
- Operational centre alarming
- Automotive, events-based notification

Our alarm server is programmed depending on its features and demands of the user. The so-called »event engine« reacts to manual or automatic releases and provokes instantly certain processes and notifications of registered persons.

Interaction with the surrounding works either via autarkic communication ways or via a sub installation of your existing »PBX«-solution.

 Release via phone, switch or PC client/user

 Emergency and team conference

 Acknowledgement and reporting

 Digital map

 Dynamic call chain with individual thresholds

 Control center alarming

 Fast reaction to average and hitch/malfunction/breakdown

 Alarming via live announcements, audio recordings

 Alarming via phone, self phone/cell phone, SMS, e-Mail

 Dynamic modules

 Connection/linkage to BMA, EMA, or relay contacts

 Autonomous learning feature for recurring introduction

## SILENT ALARMING AMOK- AND ASSAULT ALARM

More and more often assaults at open to the public offices are publicized. Responsible in communities are requested to find and implement solutions to secure their employees. Hence, a market space is opening up.

Following advantages are interesting to end users:

- Setting off of the alarm via existent phones
- Secret button or software client
- Software as a sub-installation to every TK-solution is possible
- Repeated training for users concerning auto learning features.



## PLANT ALARMING ACCIDENT OR EMERGENCY MANAGEMENT

In business, an effective and reliable alarm server is not only necessary in breakdown or software malfunction cases. Most common scenarios are: coordination of workforce in the daily process/business or automatic provocation of processes while average.

- Automatic or manual release in emergency
- Team conferences for briefing and coordination
- Connection/Bounding to BMA or EMA
- Introduction of mobile guards





## MONITOR THE EVACUATION - THE TACTICAL DASHBOARD

The so-called tactical dashboard helps you to monitor the alarm or evacuation situation. Keep an overview of the evacuated people at any time and see who is still on the site. You can also use the dashboard to hold emergency meetings, plan and initiate actions, and track the progress of the evacuation.

The tactical dashboard can of course be accessed via the evacuation terminals, but also conveniently via your PC or smartphone. The web-based application synchronizes continuously and processes the incoming data in real-time. This is also ensured in the case of several terminals, which the current status of the individual pillars will also pass on to the others. In this way, all the recorded persons can be reconciled between the different locations

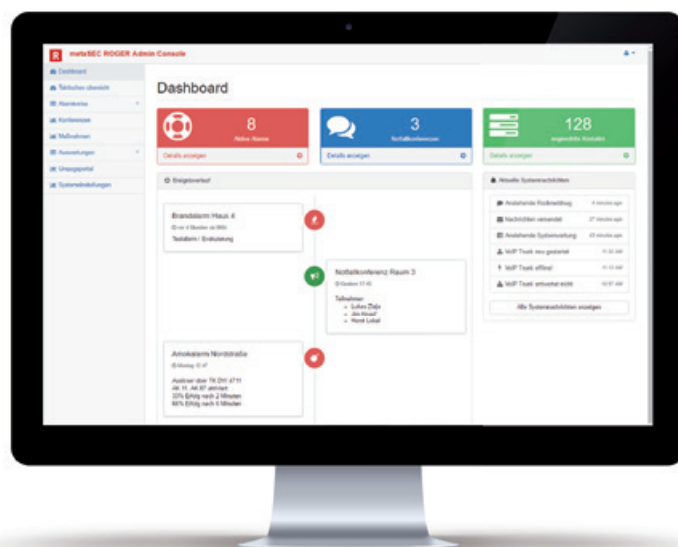

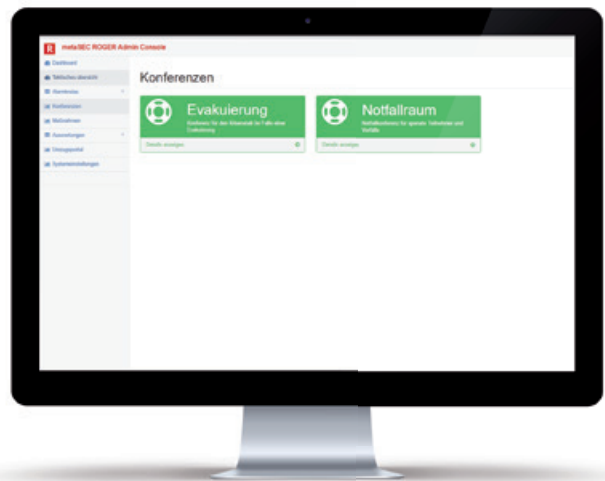
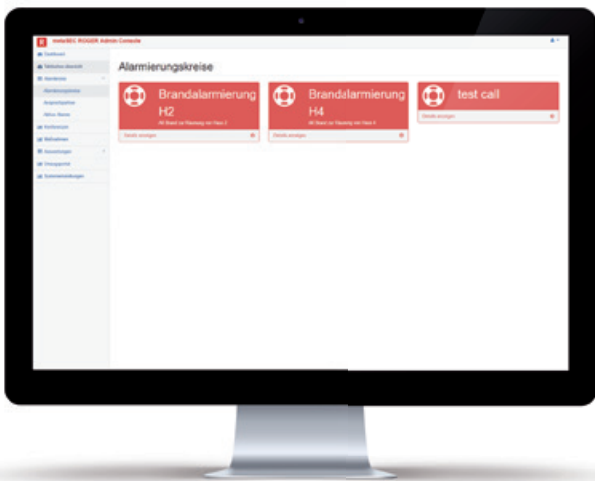



# TIMELINE OF AN ALARM

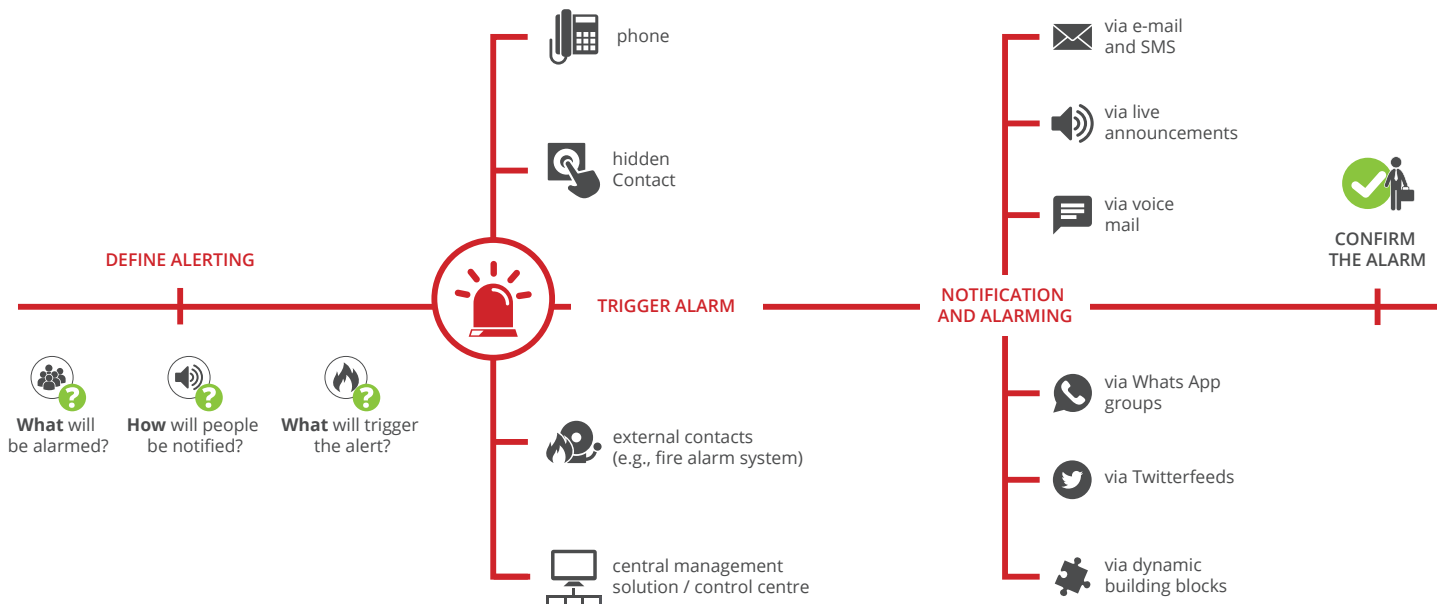

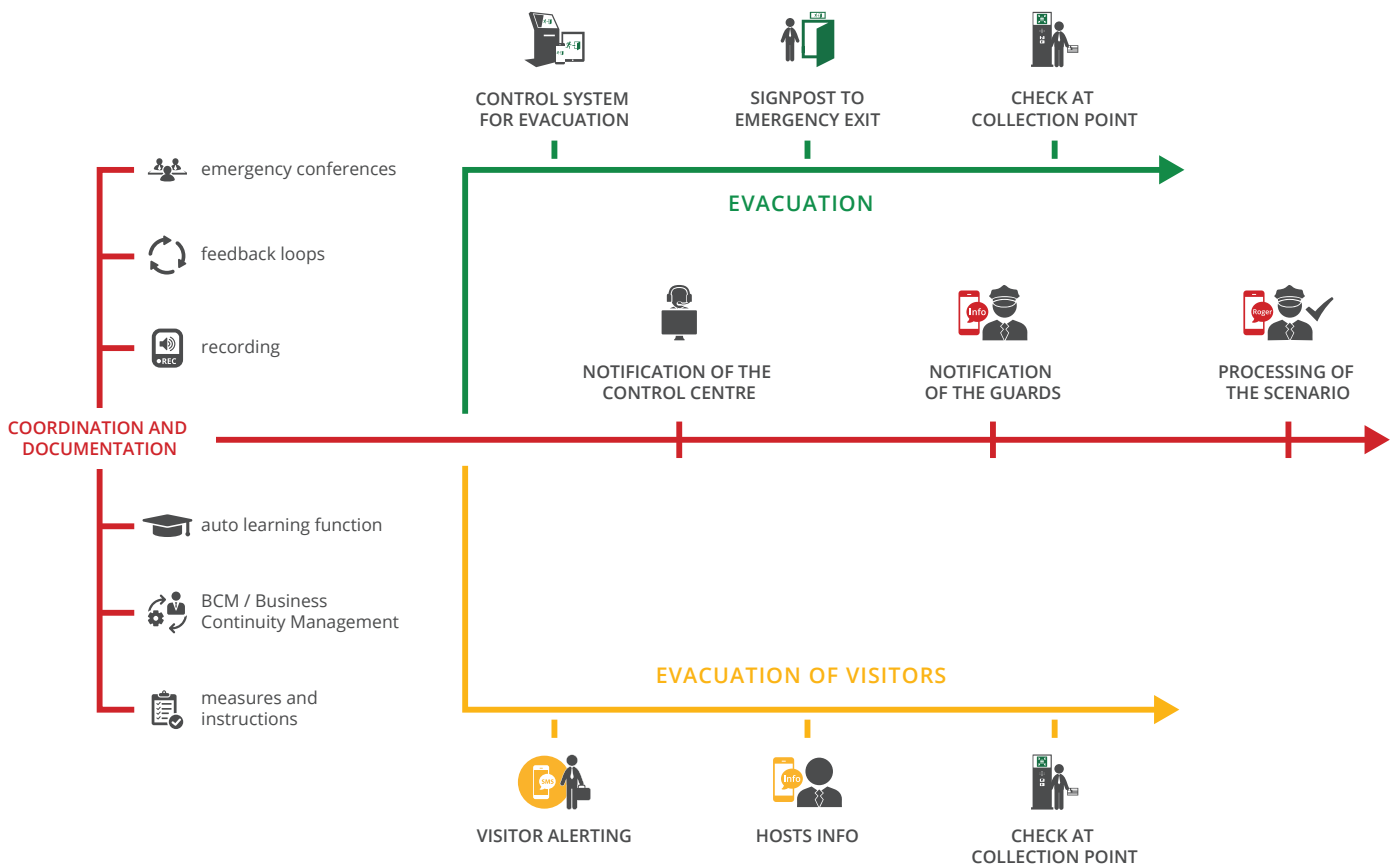

Scan the QR Code and watch the animated »ROGER Story«.





metaSEC  
Managing Director: Lukas Ziaja  
Stockumer Bruch 4  
DE-58454 Witten Stockum

Phone: +49 2302 / 98391080  
Fax: +49 2302 / 98391089  
E-Mail: [info@metasec.de](mailto:info@metasec.de)  
Web: [www.metasec.de](http://www.metasec.de)

**ALSO AVAILABLE AT :**

metaSEC\_ Assembly point brochure  
January 2018\_Nr. 01

